

A 21^a 135 ps. & all.
 B 12^a 110 ps. & all.
 34^a 85 ps. & all.

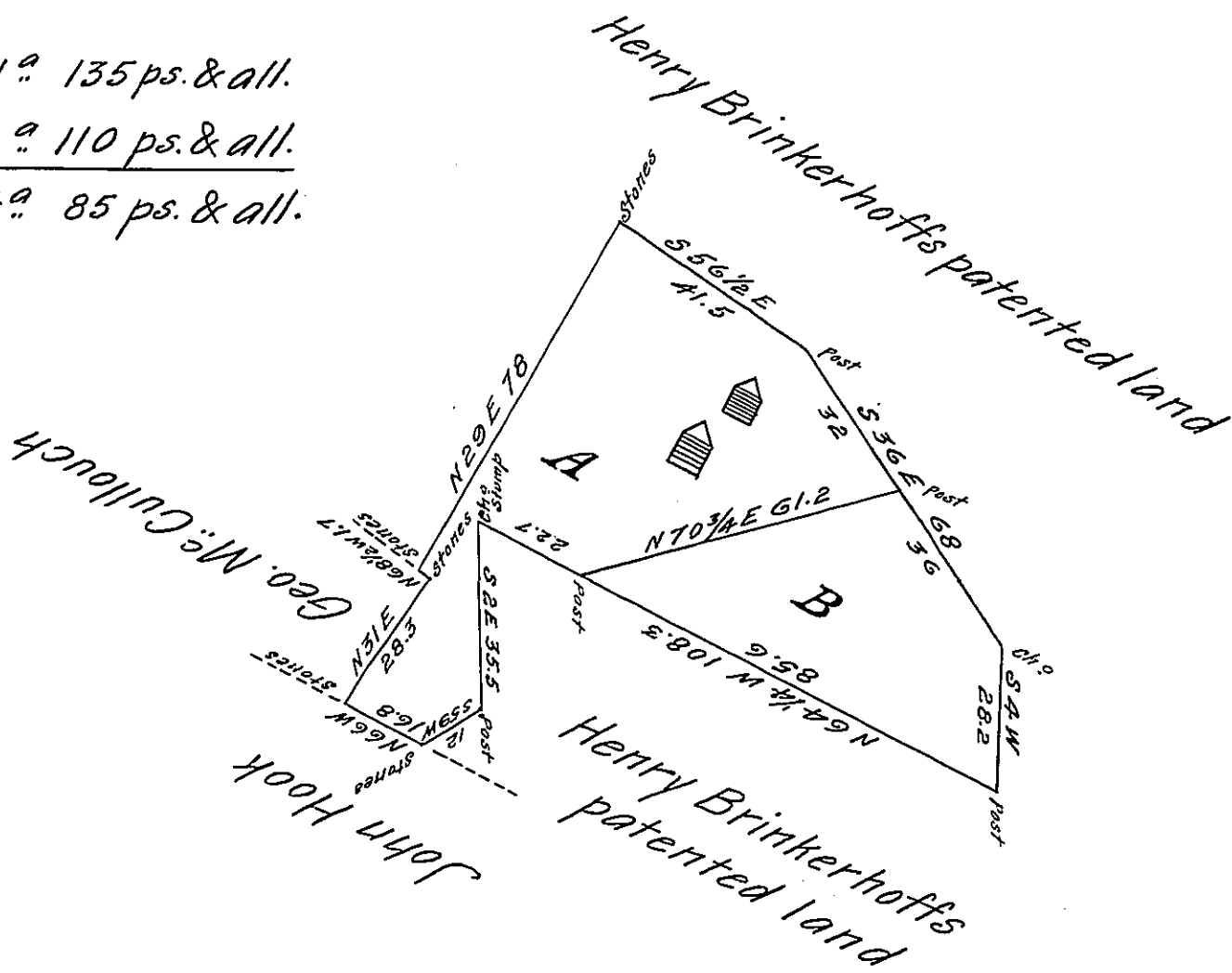

Situate in Hamiltonban Township Adams County Survey-
 ed March 14th 1821 In pursuance of a warrant granted
 to Henry Brinkerhoff for 38^a dated February 22nd 1821
 A containing twenty one acres one hundred & thirty five
 perches & alle, & B twelve acres one hundred & ten perch-
 es & allce. A is claimed by Sam! Bingaman under a war-
 rant to him for 20^a dated Nov. 17th 1820 on which are two
 houses, built previous to the Sheriffs selling the land, in
 one of which he lives, and Henry Brinkerhoff has a tenant
 residing in the other.

Sam! Sloan D.S.

To Jacob Spangler Esq^t
 Surveyor General

IN TESTIMONY that the above is a copy of the original remaining on file in
 the Department of Internal Affairs of Pennsylvania, made
 conformably to an Act of Assembly approved the 16th day of
 February, 1833, I have hereunto set my Hand and caused
 the Seal of said Department to be affixed at Harrisburg,
 this twenty-third day of March 1906

Loac D. Dawson
 Secretary of Internal Affairs.